

Zoicay

BABY SWING

MODEL: S1000

USER MANUAL

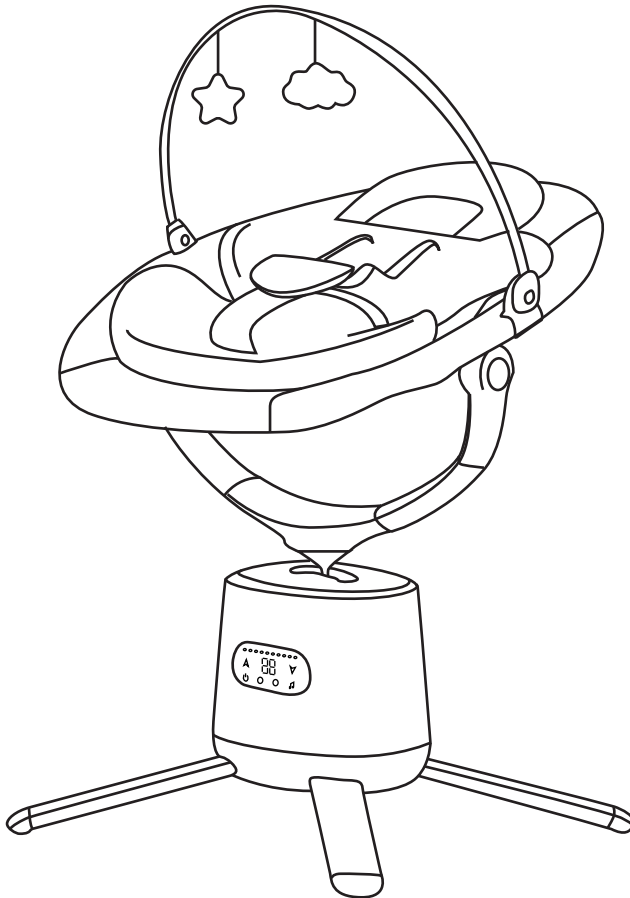

CATALOGS

SAFETY INSTRUCTIONS	-----	1-3
CLEAN & MAINTENANCE	-----	4
PART NAME	-----	4
INSTALLATION	-----	5-7
USE	-----	8-12
SPECIFICATIONS	-----	12
TROUBLESHOOTING	-----	13
WARRANTY CARD	-----	14



Android system



iOS system

SAFETY INSTRUCTIONS

WARNING

- **Prevent Serious Injury or Death: Failure to follow these warnings and assembly instructions may result in serious injury or death.**
- **Please read all instructions before using this product.**
- **Keep the user manual for future reference.**
- **This product requires adult assembly; please follow the assembly instructions carefully.**

Risk of Strangulation:

- Never hang strings or attach strings to the product.
- Cords can cause strangulation accidents, so do not place items with cords around the child's neck, such as hood strings or pacifier cords.

If this product is damaged or broken, do not continue to use it:

- Never use it as a car seat.
- Do not place this product near water sources or in damp environments; avoid placing it in bathtubs, showers, sinks, swimming pools, or other potentially wet areas.
- Never use a power adapter that has been in contact with liquid, dropped, or damaged.
- Protect the power cord carefully to avoid stepping on it or having it pinched by furniture, and do not use it with an extension cord.
- Only use the recommended transformer; do not use other models.
- Regularly inspect this product; if parts need to be replaced, contact the retailer where it was purchased, and do not attempt to replace them yourself.

WARNING:

This product contains a button or coin cell battery. A swallowed button or coin cell battery can cause internal chemical burns in as little hours and lead to death.

- Dispose of used batteries immediately.
- Keep new and batteries away from children.
- If you think batteries might have been swallowed or placed inside any part of the baby, seek immediate medical attention.



ALWAYS SECURE THE BABY IN THE PROVIDED SAFETY HARNESS.



DO NOT LEAVE THE BABY UNATTENDED IN THE SWING.

FALL and STRANGULATION HAZARDS: Children have suffered head injuries falling from swing and have strangled in straps.

- **ALWAYS** use restraints. Adjust to fit snugly.
- **NEVER** lift or carry baby in swing.
- **STOP** using swing when baby has reached 25 lbs.
- **STOP** using swing when infant attempts to climb out (approximately 9 months).
- The upright position is only for children who have developed enough upper body control to sit up without tipping forward.
- **ALWAYS** place swing on floor. Never use on any elevated surface.

SUFFOCTION HAZARD: Babies have suffocated when seats tipped over on soft surfaces.

- **Never** use on a bed, sofa, cushion, or other soft surface.
- Stay near and watch baby during use.

This product is not safe for sleep or unsupervised use.

If baby falls asleep, remove baby as soon as possible and place baby on a firm, flat sleep surface such as a crib or bassinet.

FALL and STRANGULATION HAZARDS: Infants have suffered head injuries falling from Swings and have strangled in straps.

- **ALWAYS** use restraints. Adjust to fit snugly.
- Stay near and watch baby during use. This product is not safe for sleep or unsupervised use. If baby falls asleep, remove baby as soon as possible and place baby on a firm, flat sleep surface such as a crib or bassinet.

SUFFOCATION HAZARDS: Young infants have limited head and neck control. If the seat is too upright, infant's head can drop forward and compress the airway.

- **ALWAYS** keep swing seat fully reclined until infant is at least 4 months old AND can hold up head without help.

CAUTION

To prevent battery leaks, which can burn skin and eyes:

- Always replace the entire set of batteries at one time.
- Never mix old and new batteries, or batteries of different brands or types.
- Remove batteries when storing product for a long time.
- Dispose of used batteries immediately.

WARNING:

Changes or modifications to this unit not expressly approved by the party responsible for compliance could void the user's authority to operate the equipment.

NOTE: This equipment has been tested and found to comply with the limits for a Class B digital device, pursuant to Part 15 of the FCC Rules. These limits are designed to provide reasonable protection against harmful interference in a residential installation. This equipment generates, uses and can radiate radio frequency energy and, if not installed and used in accordance with the instructions, may cause harmful interference to radio communications.

However, there is no guarantee that interference will not occur in a particular installation. If this equipment does cause harmful interference to radio or television reception, which can be determined by turning the equipment off and on, the user is encouraged to try to correct the interference by one or more of the following measures:

- Reorient or relocate the receiving antenna.
- Increase the separation between the equipment and receiver.
- Connect the equipment into an outlet on a circuit different from that to which the receiver is connected.
- Consult the dealer or an experienced radio/TV technician for help.

CLEANING & MAINTENANCE

CLEANING

1. Gently wipe the host, legs and seat frame with a damp cloth and mild detergent, then dry thoroughly. Do not use strong detergents.
2. For the mattress component: remove it, add a small amount of detergent, and wash gently. After washing, please dry in a cool place away from direct sunlight.

Maintenance

1. Check the baby swing regularly to ensure that all parts are firmly connected.
 2. If the connection is not firm, stop using it immediately and reconnect or reinstall it.
- This product contains electronic components. Do not immerse it in water or other liquids.
 - Keep the product dry and store it in a cool and dry place. Avoid prolonged exposure to sunlight.

PART NAME



Host

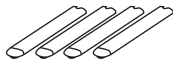

Leg



Left support bracket



Right support bracket

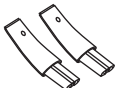

Extended support bracket



Seat tube A



Seat tube B



Mattress component



Toy bracket



Toy

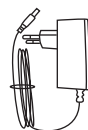

Power adapter



User manual

INSTALLATION

⚠️WARNING: This product is only for adult installation!

1. Insert the four "legs" into the corresponding holes of the host, making sure they are in the correct direction, until you hear a "click" sound, indicating that the assembly is complete and firmly fixed.

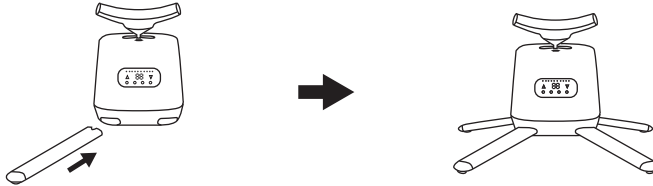

2. Install the "left support bracket" and "right support bracket" on the "extended support bracket" respectively, and then install the whole on the host.

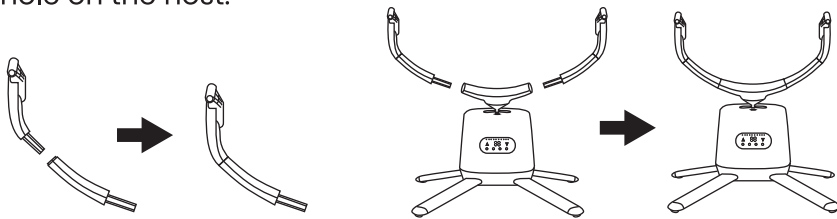

3. Seat tube installation:

a. Combine "Seat tube A" and "Seat tube B" to form two "Seat tube combinations".

b. Insert the "seat tube combinations" into the corresponding holes of the "Left support bracket" and "Right support bracket" respectively.

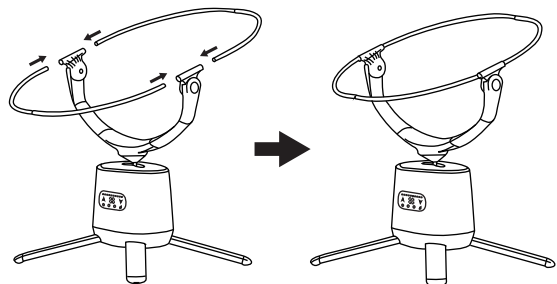
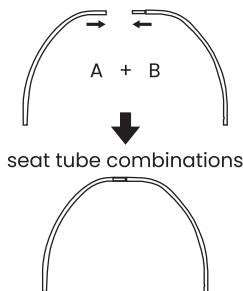

4. Install the "mattress component"

Note: It is easy to make mistakes here, so please make sure to confirm the installation direction, make sure the "left support bracket" is on the left side (marked A), and the "right support bracket" is on the right side (marked B). Meanwhile, please make sure that the side with the "pillow" on the "mattress component" is facing up, as shown in the figure below.

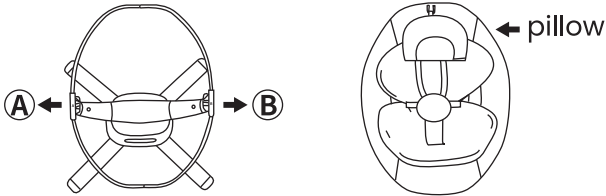

- a. Lift the cloth cover at the bottom of the "mattress component" with both hands and wrap the seat tube in it (as shown in Figure 1 below).
- b. Open the edge cloth at the bottom of the "mattress component", wrap the seat tube in it, and then pull up the zipper with both hands (as shown in Figure 2 below).
- c. The "mattress component" will be installed as shown in Figure 3 below.

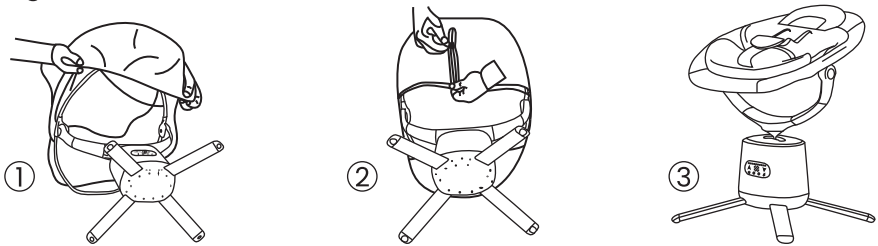

5. Installation of toy bracket and toys

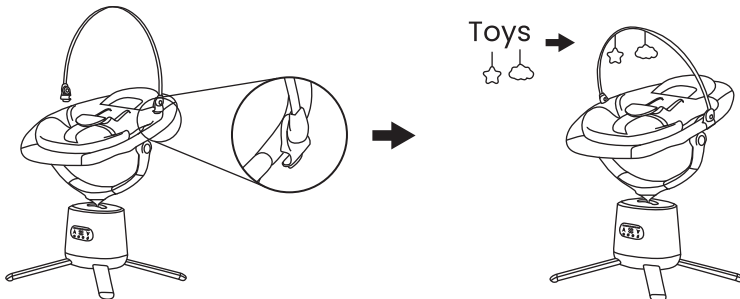

6. Installation and use of seat belts

Place your baby in the seat, fasten the safety buckle, cover the safety buckle with protective cloth, and adjust the length of the shoulder belt and waist belt. The five-point safety belt can effectively protect your baby and ensure that the child sits comfortably; please refer to the pictures below for details.

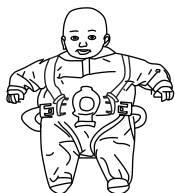

1. Place the baby in the seat;



2. Tighten the five point safety buckle;



3. Cover the safety buckle with protective cloth.

SPECIAL ATTENTION:

In order to prevent the seat belt from being accidentally opened by the baby, according to US law, we have designed the buckle to be very tight. Please open it with both hands according to the diagram.

The length of the seat belt can be adjusted by pressing the buttons on the shoulders and waist to ensure that the baby sits comfortably and safely.

USE

Seat adjustment

There are two angles of adjustment, as shown below:

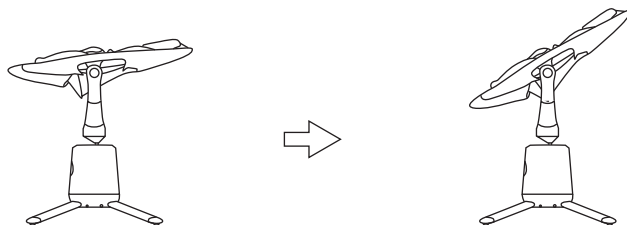

Operation method:

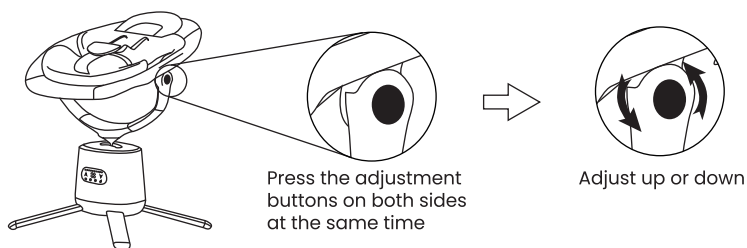

Seat rotation function

The seat can be rotated 360° to the left or right, and the angle can be adjusted freely according to personal preference.

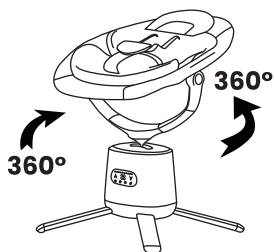

Power supply

Use the included DC power adapter.

Insert the round end of the adapter into the machine, and then insert the other side (adapter plug) into the power socket, as shown in the figure.

(Adapter input voltage: 100-240V, 50/60Hz, 0.8A MAX; output voltage: 12.0V \equiv 2.0A, 24.0W.)

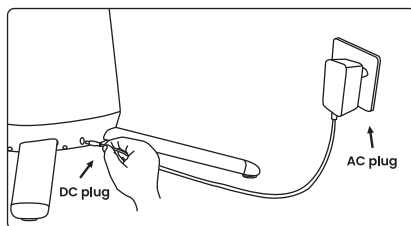

! WARNING:

- DO NOT USE AN ADAPTER OTHER THAN THE ONE SUPPLIED WITH THE PRODUCT!
- WHEN USING THE ADAPTER, BE SURE TO KEEP IT OUT OF THE REACH OF CHILDREN.

Introduction to control panel functions:

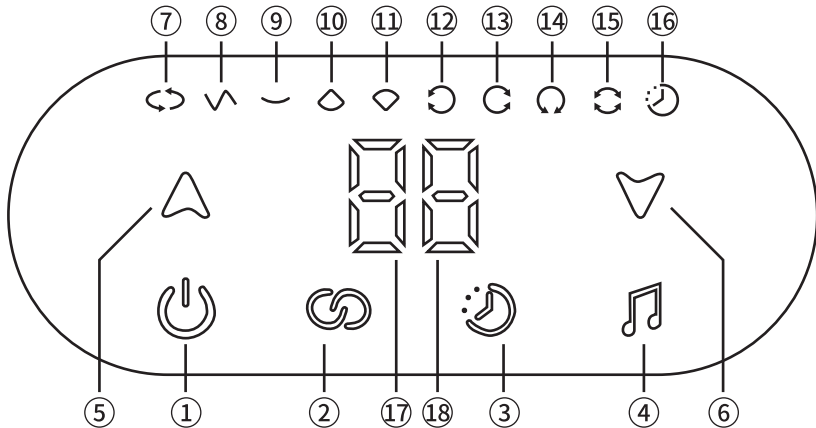

- ① Power button (short touch to turn on, again short touch to stop the swing, long touch for 3 seconds to turn off)
- ② Mode conversion button (switch No.7-15 swing modes by operation)
- ③ Timer button (9 gears in total, 10 minutes for each gear, 90 minutes in total)
- ④ Music button (Press the "music button" to play music (a total of 12 songs) -press it again to pause the music,press it again to play the next song, and press it again to pause, and so on. Long press the"music button" to adjust the volume, and release it after confirming the volume.)
- ⑤ Gear-up Button (to increase the speed of the No. 7-15 swing modes, each mode has 8 speed gears)
- ⑥ Gear-down Button (to reduce the speed of the No. 7-15 swing modes, each mode has 8 speed gears)
- ⑦ Cycle mode (cycle the No. 8-15 swing modes, each mode cycles 10 times)
- ⑧ Soothing Mode (circle + swing)
- ⑨ Swing mode (nodding up and down and rocking horizontally)
- ⑩ Pendulum mode (positive arc swing)
- ⑪ Mother's Embrace Mode (reverse arc swing)
- ⑫ Left Swing Mode (located on the left side of the panel, swinging in circles)
- ⑬ Right Swing Mode (located on the right side of the panel, swinging in circles)
- ⑭ Center Swing Mode (located near the center of the panel host and swings in circles)
- ⑮ Orbit Mode (swing to the left side of the panel and circle twice, swing to the right side of the panel and circle twice, and repeat this cycle)
- ⑯ Timer indicator light
- ⑰ Left digital display (shows the speed gear of each mode)
- ⑱ Right digital display (shows the timer gear of each mode)

Remote Control Instructions

Before using the remote control, please remove the power off plastic sheet to ensure the normal operation of the remote control.

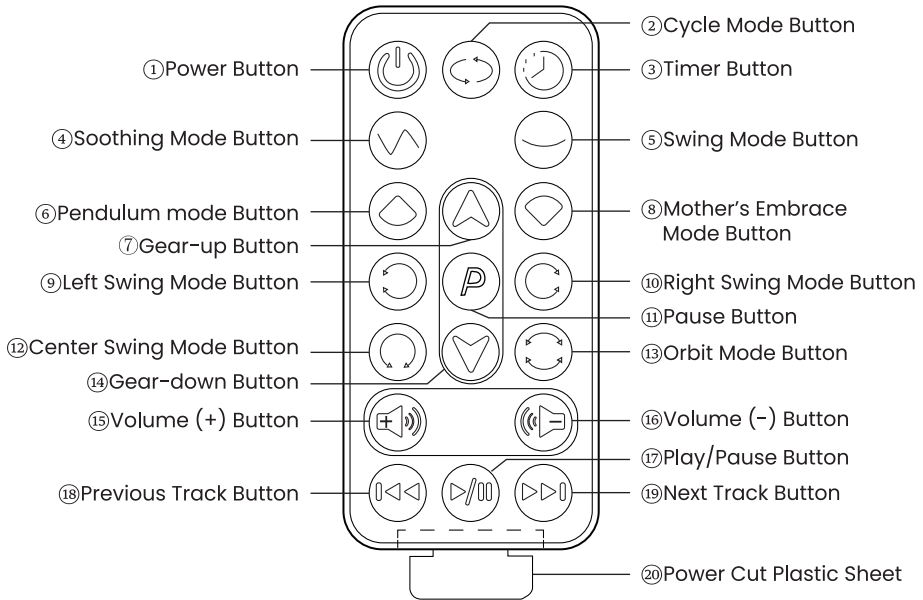

Mobile phone remote control description

1. Download and install

Please select the corresponding QR code according to your phone's operating system to scan and download. The specific steps are as follows:

- Identify the system: first confirm whether your phone's operating system is **Android** or **iOS**.
- Scan the QR code:
If your phone is Android , please scan the QR code labeled "**Android**".
If your phone is iOS, please scan the QR code labeled "**iOS**".
- Download and install: After scanning the code, click the link to download and install the remote control.
- Using the remote control: After the installation is completed, you can use the mobile remote control to operate.



Android system



iOS system

Note: Please select the correct QR code according to your cell phone type to make sure the downloaded remote control application is compatible with your device.

2. Bluetooth connection

Follow the steps below to connect the remote control app on your phone to the baby swing via Bluetooth:

a. Turn on your phone's Bluetooth

- Click "Settings" on your phone, find the "Bluetooth" option and make sure the Bluetooth switch is turned on.
- Make sure your phone is discoverable so other devices can find it.

b. Open the remote control app on your phone

- Launch the remote control app you downloaded for your phone.

c. Get to the Bluetooth Search screen

- On the Phone Remote app screen, find and tap on the "Bluetooth Location" option. This will take you to the Bluetooth search screen.

d. Search for devices:

- Wait for the app to search for nearby Bluetooth devices. In the search results, look for the Bluetooth device named "TY388".

e. Connect the device:

- Click "TY388" to pair and connect.

After successful connection, you can use the remote control of your phone to operate Baby Swing

CAUTION

- **Make sure the Baby Swing is in working condition and not connected to other devices before connecting to your phone's remote control app.**
- **If the connection fails, try restarting your phone's Bluetooth or remote control app and retry the connection steps.**

Bluetooth Location

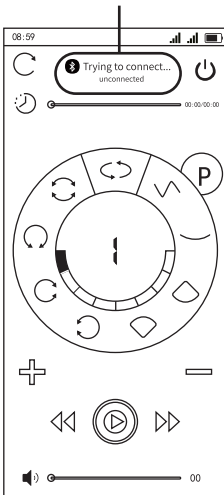

CONNECT

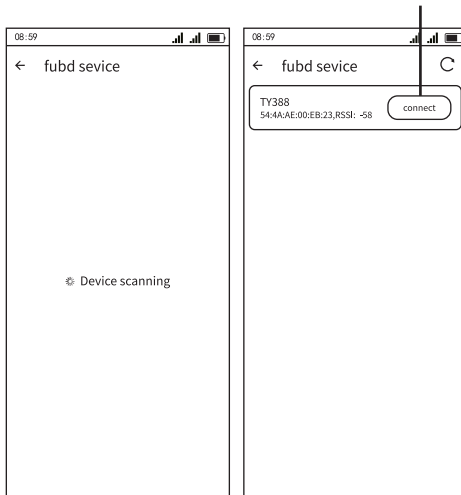

TY388

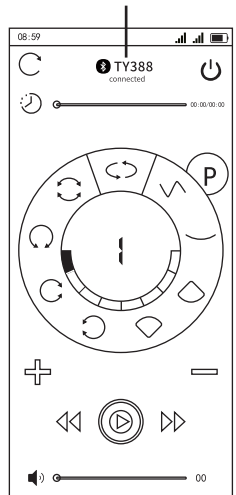

3. Mobile Remote Control Function Introduction

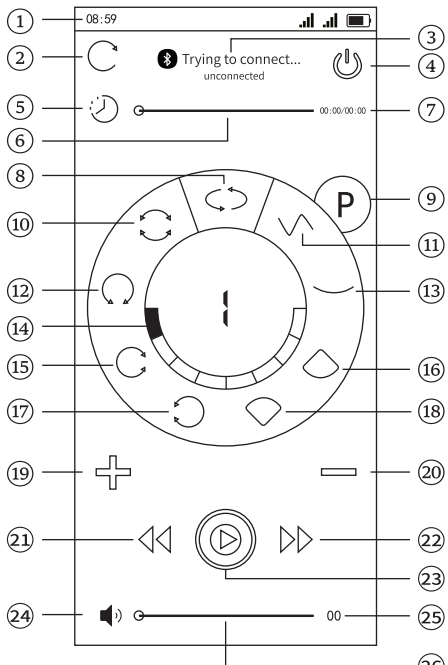
- 
- The diagram shows a mobile app interface for a baby swing. At the top, there's a status bar (1) with the time 08:59, signal strength, and battery level. Below it is a connection status area (2) with a refresh button (3) and a power button (4). A timer icon (5) and a timer drag bar (6) are shown, with a real-time display (7) showing 00:00:00. The main control area is a large circular dial (8) with various modes: Cycle mode (9), Pause (10), Orbit Mode (11), Soothing Mode (12), Center Swing Mode (13), Swing mode (14), Right Swing Mode (15), Pendulum Mode (16), Left Swing Mode (17), and Mother's Embrace Mode (18). Each mode has a corresponding speed display bar (14). Below the dial are gear-up (19) and gear-down (20) buttons. At the bottom, there are track navigation buttons: Previous Track (21), Play/Pause (23), and Next Track (22). A volume button (24) and a volume adjustment real-time display (25) are also present, with a volume control bar (26) below them.
- ① Cell phone real-time status bar
 - ② Connection Refresh Button
 - ③ Connected and disconnected display
 - ④ power button
 - ⑤ Timer icon
 - ⑥ Timer drag bar, up to 90 minutes
 - ⑦ Timer real-time display
 - ⑧ Cycle mode Button
 - ⑨ Pause Button
 - ⑩ Orbit Mode Button
 - ⑪ Soothing Mode Button
 - ⑫ Center Swing Mode Button
 - ⑬ Swing mode Button
 - ⑭ Each mode 1-8 speed display bar, this frame is 1 speed
 - ⑮ Right Swing Modo Button
 - ⑯ Pendulum Mode Button
 - ⑰ Left Swing Modo Button
 - ⑱ Mother's Embrace Model Button
 - ⑲ Gear-up Button
 - ⑳ Gear-down Button
 - ㉑ Previous Track Button
 - ㉒ Next Track Button
 - ㉓ Play/Pause Button
 - ㉔ Volume Button, click to mute
 - ㉕ Volume adjustment real-time display, up to 100
 - ㉖ Volume control bar

SPECIFICATIONS

Product Name: Baby swing

Product mode: S1000

Input voltage: 100-240V ~ 50/60Hz, 0.8A MAX

Output voltage: 12.0V = 2.0A 24.0W

Warning: Do not use the non-matching adapter

TROUBLESHOOTING

SITUATION	CAUSE	SOLUTION
Not working	No power supply	Connect the power
Difficult to install	No instructions	Please follow the instructions on the installation guide card
Missing accessories	Parts missing	Please contact customer service
Too loud/quiet	Volume adjustment	Adjust via the panel: long press this button to adjust the volume
		Adjust via the "Volume" button on the remote control
		Adjust by mobile remote control
Unsteady base	Uneven floor	Use on an even floor
	"Legs" not firmly installed	Inspect and reinstall
Strange smell	Not cleaned in time	Perform regular maintenance and clean the "mattress component"
Bluetooth cannot be searched	The machine is not turned on	Turn on the machine
	being used on another phone	Turn off the Bluetooth of the connected phone
	The distance is too far	Use the APP within 12 meters
Remote control failure	The remote control is not aimed at the machine panel	Aim at the panel first and then press the remote control button
	Obstruction	When using, there should be no objects between the remote control and the baby swing

"Note: If you have further questions, please contact our customer service. Please do not disassemble and repair the baby swing by yourself."

BABY SWING

WARRANTY CARD

DATE OF PURCHASE:※		WARRANTY PERIOD 12 months from the date purchase
CUSTOMER INFORMATION	NAME:	
	※ Email:	
Tel:()		
ORDER INFORMATION	Account name: ※ Order Number:	

CAUTION: INFORMATION IS NECESSARY, OTHERWISE YOU MAY NOT RECEIVE FREE REPAIRS.

WARRANTY NOTE:

1. We will repair or replace the product free of charge if it breaks down or is damaged normal use conditions according to the instruction manuals, labels attached to the main unit, etc.
2. Please contact our service Email: support@zoicaybaby.com for free repairs within the warranty period
3. please keep your order number
4. Even within the warranty period, repairs will be charged in the following cases
 - ① Failure in use Failure or damage due to improper repair or modification
 - ② Failure and damage due to falling after purchase
 - ③ Failure and damage due to fire, earthquake, and other natural disasters
 - ④ Failure and damage when used for non-home use (for example, long-term use for business, installation on vehicle/ships)
 - ⑤ Failure and damage due to movement, transportation or contact with fixtures, etc. after purchase
 - ⑥ If this document is not presented
5. This book is valid only in the USA
6. This manual will not be reissued, so please keep it carefully so that it will not be lost

CUSTOMERS PRIVILEGE

Please fill in the warranty card, contact Zoicay customer service email, you can have below privilege:

1. **FEE REPAIR** **UP** **FREE REPLACEMENT**
2. Big discount available!

CONTACT US NOW!

INSTRUCTIONS

Step 1: Please fill in the warranty card

Step 2: Take a photo of or scan the warranty card:

Step 3: Send in to Zoicay customer service Email:

support@zoicaybaby.com

+1(844) 668-8123